

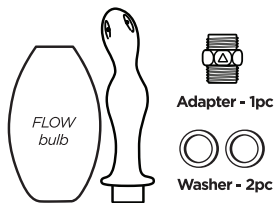

Wet Works FLOW

SILICONE ANAL DOUCHE AND ACCESSORY

Instructions for Assembly



Flow Flush
2401-21-BX

Fill
2401-23-BX

Extra Deep
2401-25-BX

Pleasure
2401-27-BX

TIPS SOLD SEPARATELY

Flow Full Flush Set 2401-20-BX
(includes everything above all in one set)



Tip for attaching adapter to bulb

ATTACH ADAPTER TO ACCESSORY BEFORE SCREWING INTO THE BULB AND FIRMLY SCREW IN TO SEAL.

- ▶ Washers are not necessary when used with FLOW bulb.
- ▶ Washers must be installed before attaching to shower hose.
- ▶ When installing the Adapter, the arrow Δ is always pointing toward the spray nozzle.

To assemble Kink Wet Works FLOW douche:



Arrow  should always point toward spray nozzle.

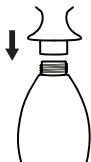
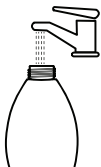

1

Push Adapter into Kink Wet Works FLOW bulb and firmly screw in to seal.

2

Fill FLOW bulb with water.

3

Insert threaded base of Accessory over bulb and twist to seal.

To attach Kink Wet Works FLOW accessories to hand-held shower hose*:



1

Remove your hand-held showerhead from its hose.

**Showerhead and hose not included*



2

Place one Washer at each end of Adapter.

3

Aligning arrows, screw Adapter onto Accessory ("Pleasure", "Extra Deep" or "Fill")

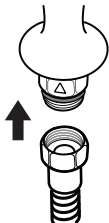

4

Twist assembled Accessory with Adapter onto your shower hose.

