



RING & PLUG SET

SILICONE & STAINLESS STEEL COCK ACCESSORIES

Instructions for Use

This pre-assembled set promises a unique experience for new and advanced enthusiasts of urethral play. Set includes four stainless steel cock plugs and base on premium silicone cock rings, and a neoprene case for storage or travel.



BRANDED NEOPRENE CASE FOR DISCREET TRAVEL/STORAGE

PREMIUM SILICONE COCK RING

- Plumps and sensitizes head
- Inner Diameter: 1.15" (29 mm),
Depth: 0.2" (5 mm)

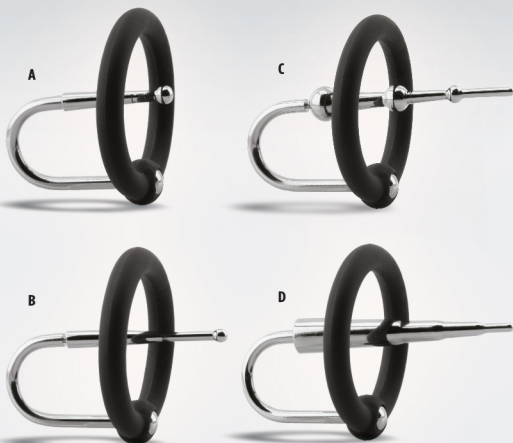

A | MEDIUM BEAD END

- Smooth Flared Rod
- Length: 1" (2.54 cm),
Max Width: 0.15" (0.39 cm)

C | 3 GRADUATED BEADS

- Smooth Flared Rod
- Length: 2" (5.08 cm),
Max Width: 0.3" (.76 cm)

B | SMALL BEAD END

- Smooth Slim-to-Flared Rod
- Length: 1.4" (3.56 cm),
Max Width: 0.15" (0.39 cm)

D | 5 GRADUATED WIDTHS

- Textured Flared Rod
- Length: 2" (5.08 cm),
Max Width: 0.3" (.76 cm)

1

Before use, fully sterilize your Kink Ring & Plug Set by boiling for at least 10 minutes. Allow to cool, wash your hands with antibacterial soap, and apply hand sanitizer or sterile gloves before handling.



2

Choose the plug you want to use and apply the sterile lubricating gel of your choice (not included) to the stainless steel plug and urethral opening. Beginners should start with one of the smaller/slimmer plug shapes.

3

Begin gently sliding the plug inside, giving your body time to adjust.

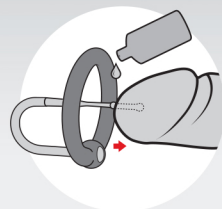

4

When the plug has been partially inserted and the silicone ring touches your skin, continue inserting the plug and slip the ring around the head of the penis in one streamlined motion.

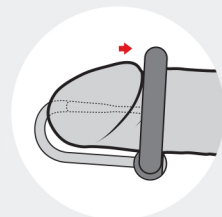

5

Sanitize by boiling after use. Allow to cool and air-dry before storing.

Safe, sane, and consensual (SSC) is one of the values surrounding ethically acceptable behavior in BDSM, kink, and alternative sexuality communities. Safe means that the risk of activities should be understood by all participants, taking all precautions to prevent accidents or injury. Sane is to undertake activities in a sensible and sane state of mind, understanding the difference between fantasy and reality. Consensual means that all parties have freely and fully consented to the activity and were in a sound state of mind.

Not suitable for long-term wear. If you experience any unusual pain or distress, stop use immediately and seek medical attention. Individuals prone to urinary tract infections or other conditions affecting the urinary tract should not use this product. Doc Johnson disclaims all liability for injury, distress, or damages occurring during use of this product and sells it as a novelty only.